

# Eumachia's Building in Pompeii

Kathryn Welch  
University of Sydney

[Kathryn.Welch@usyd.edu.au](mailto:Kathryn.Welch@usyd.edu.au)



D'ARMS, J.H. (1988): 'Pompeii and Rome in the Augustan Age and Beyond: the Eminence of the *Gens Holconia*,' in in R.I.Curtius (ed), *Studia Pompeiana et Classica*, Vol. 1. New Rochelle, New York: 51–68.

DOBBINS, J.J. (1994): The Problems of Chronology, Decoration and Urban Design in the Forum at Pompeii, *American Journal of Archaeology*, 98: 629–694.

DOBBINS, J.J., Ball. L.F., Cooper, J.G., Gavel, S., Hay, S. (1998): Excavations in the Sanctuary of Apollo at Pompeii 1997, *AJA* 102: 739–756.

THE POMPEII FORUM PROJECT <http://pompeii.virginia.edu/>

RICHARDSON, L. (1978): Concordia and Concordia Augusta: Rome and Pompeii' *Parola del Passato* 33: 260–271.

Baths

Palaestra

Forum

Temple of Apollo

Temple of Venus

Basilica

Theatre

Amphitheatre



Overview of major public spaces

Zanker's view of the impact of colonisation on the cityscape

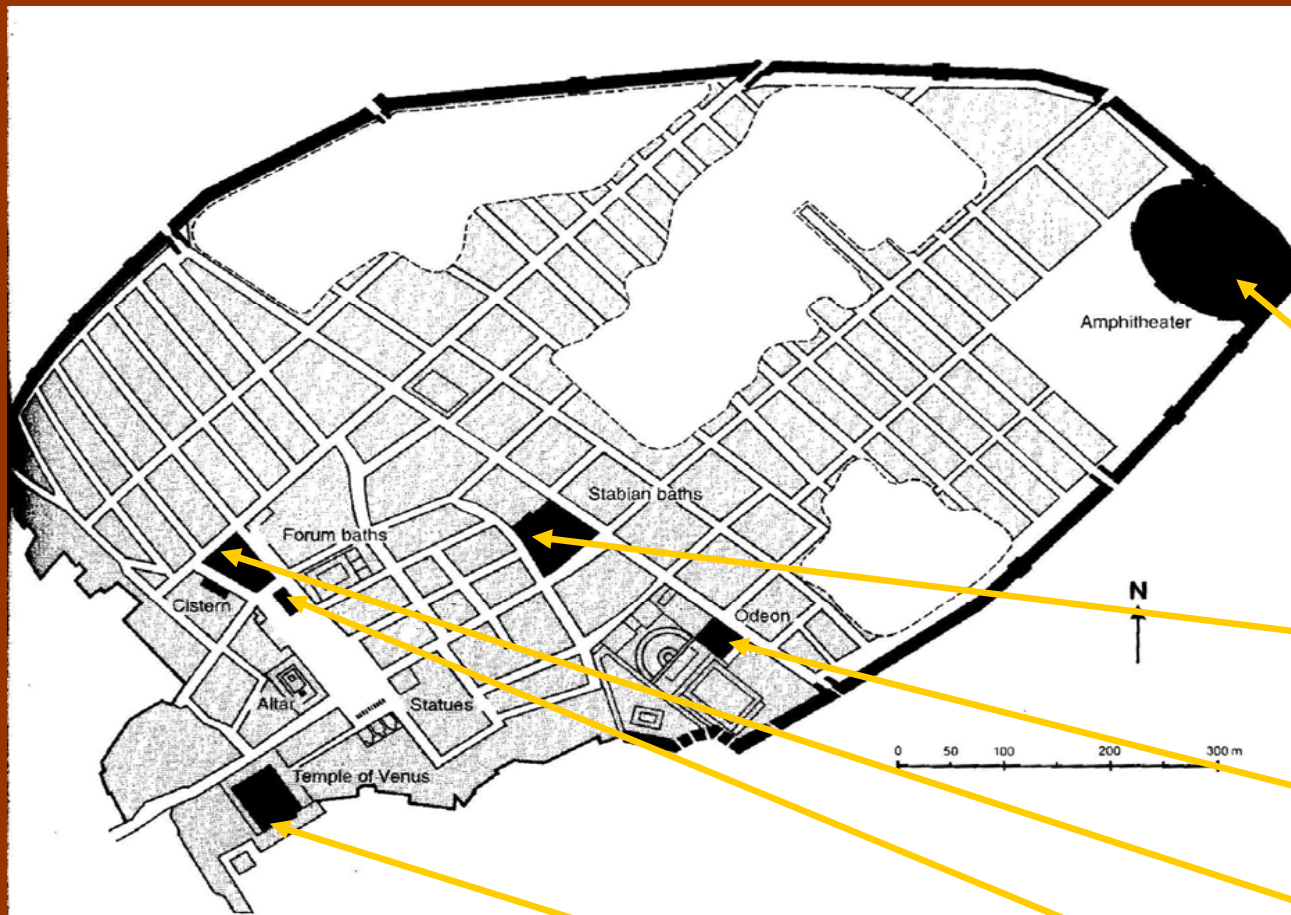

Amphitheatre

Stabian Baths  
(renovated)

Odeon

Forum Baths

Capitolium

Temple of Venus

*Figure 24* Plan of Pompeii with sites of public buildings erected after the founding of the Roman colony in 80 B.C. On their arrival the colonists found a town already equipped with the most important facilities. Their new construction reflects new requirements, most spectacularly a giant amphitheater far surpassing the needs of the town itself, which was financed by two rich partisans of Sulla. The location on the extreme edge of town shows that large numbers of visitors from the hinterland were expected. Some of the colonists were presumably settled in the surrounding countryside, where numerous farmyards have been discovered.

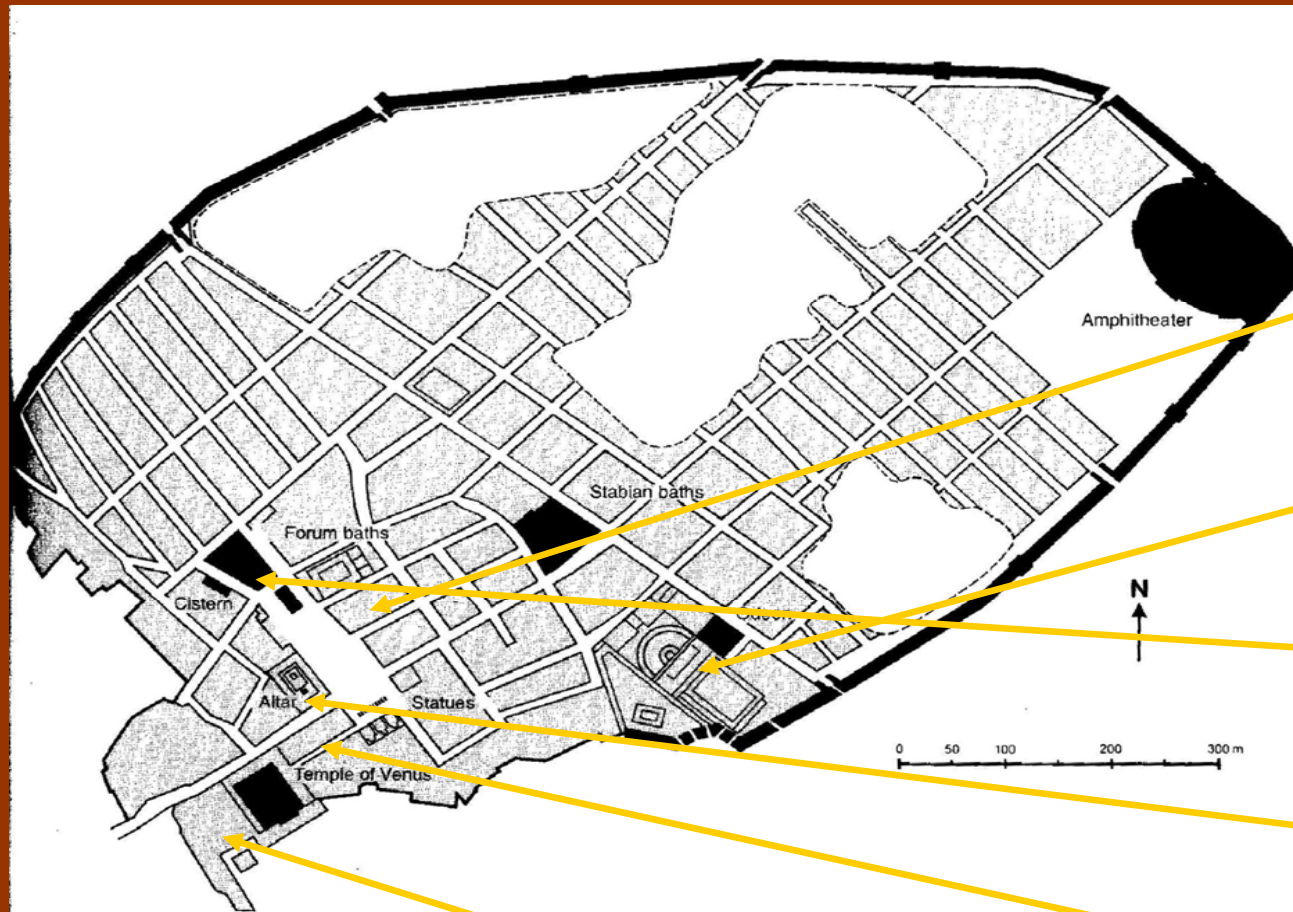

## 'Augustan' Renovation

East side of the Forum

Theatre

Forum Baths

Temple of Apollo

Basilica

Temple of Venus

*Figure 24* Plan of Pompeii with sites of public buildings erected after the founding of the Roman colony in 80 B.C. On their arrival the colonists found a town already equipped with the most important facilities. Their new construction reflects new requirements, most spectacularly a giant amphitheater far surpassing the needs of the town itself, which was financed by two rich partisans of Sulla. The location on the extreme edge of town shows that large numbers of visitors from the hinterland were expected. Some of the colonists were presumably settled in the surrounding countryside, where numerous farmyards have been discovered.

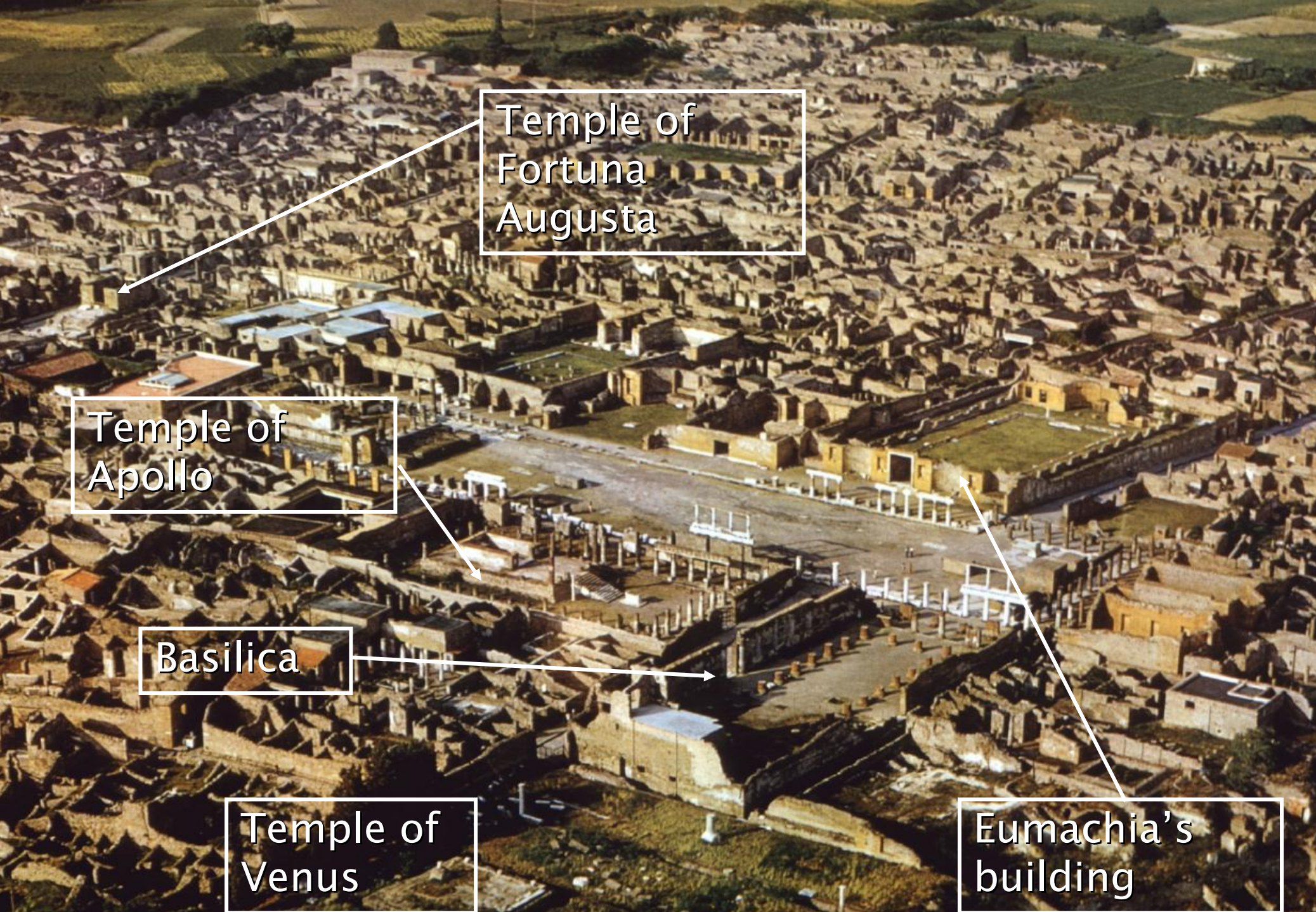

Temple of  
Fortuna  
Augusta

Temple of  
Apollo

Basilica

Temple of  
Venus

Eumachia's  
building

# Temple of Fortuna Augusta

(late 1<sup>st</sup> Century BC)

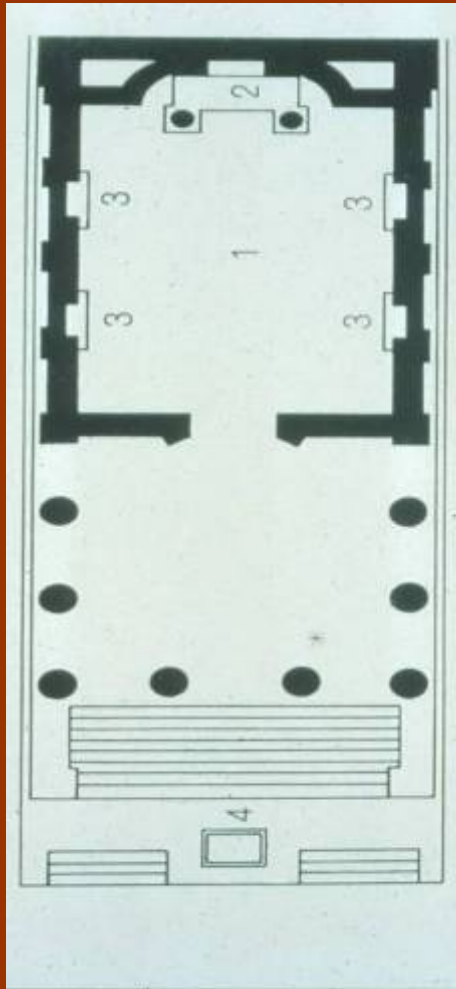

## CIL 10, 820

M TVLLIVS M F D V I D TER QVINQ AVGVTR TR MIL  
A POP AEDEM FORTVNAE AVGVST SOLO ET PEQ SVA

Marcus Tullius, son of Marcus, duumvir for legal jurisdiction for the third time, quinquennial duumvir, augur, military tribune a populo built the temple of Augustan Fortune on his own land and at his own expense.

## CIL 10, 822

M TVLLIVS M F] [ V I D III | QVINQ AVG[ ]TRIB MIL |A  
POPVLO[



# Temple of Venus (Colonia Cornelia Veneria Pompeianorum)

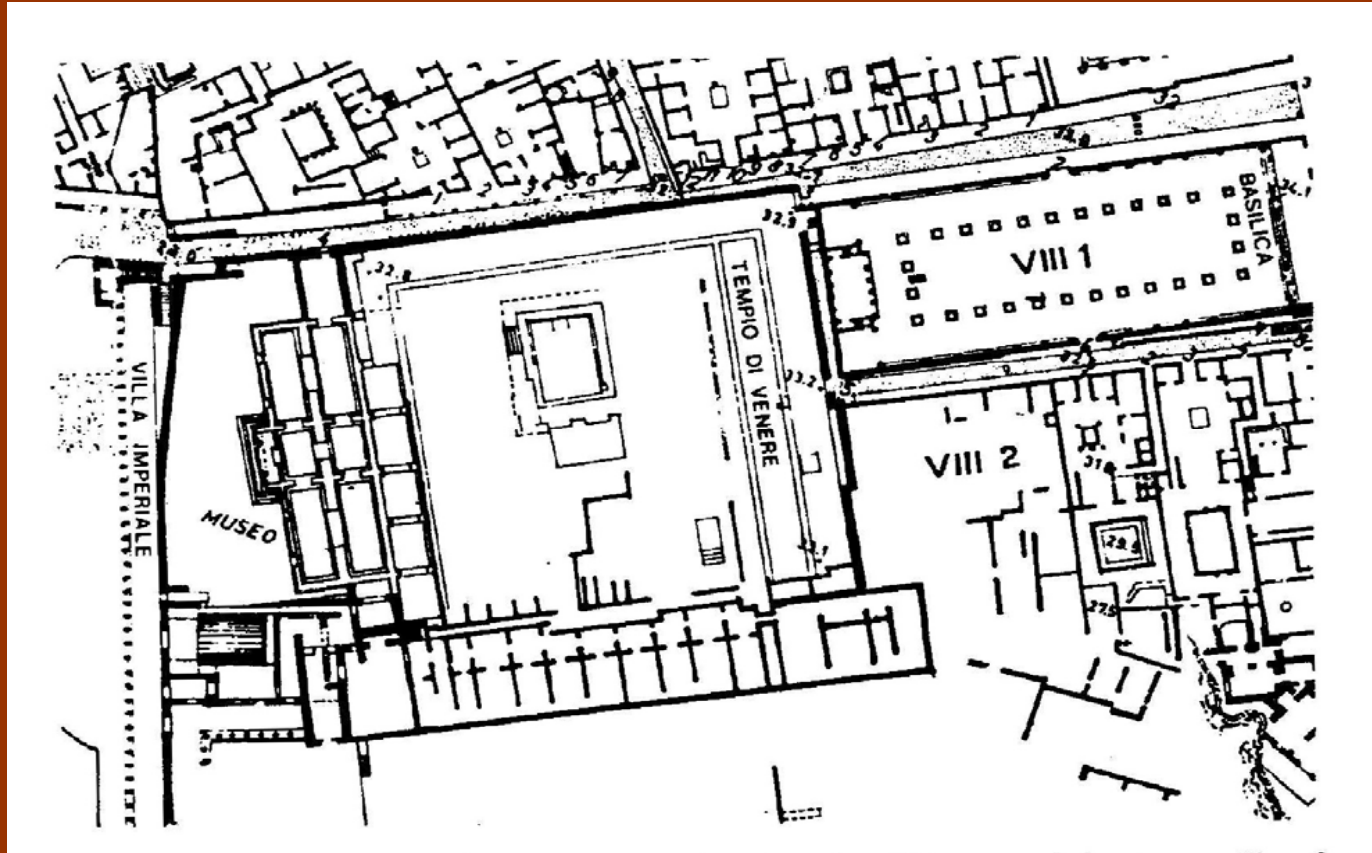

<http://www.shef.ac.uk/archaeology/research/venus/venus.html>

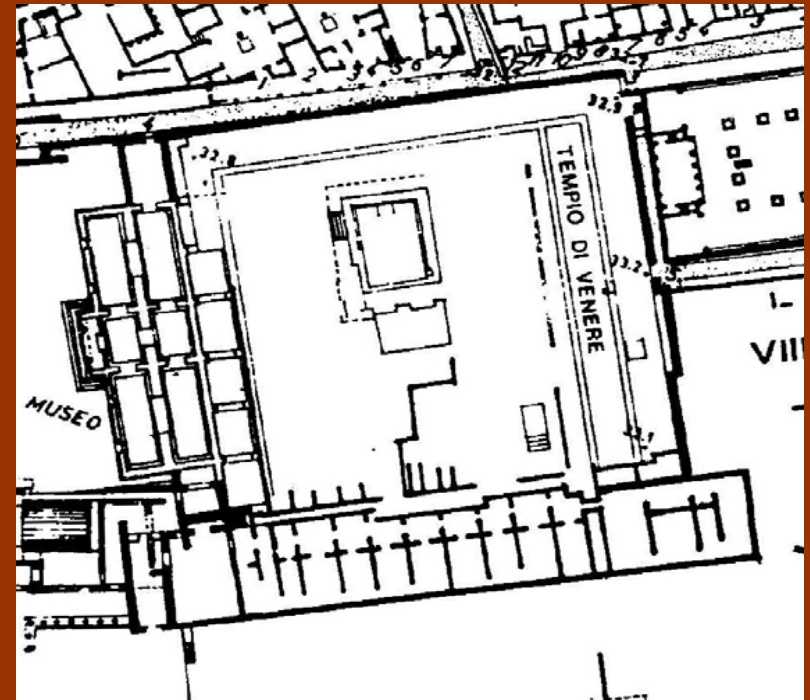
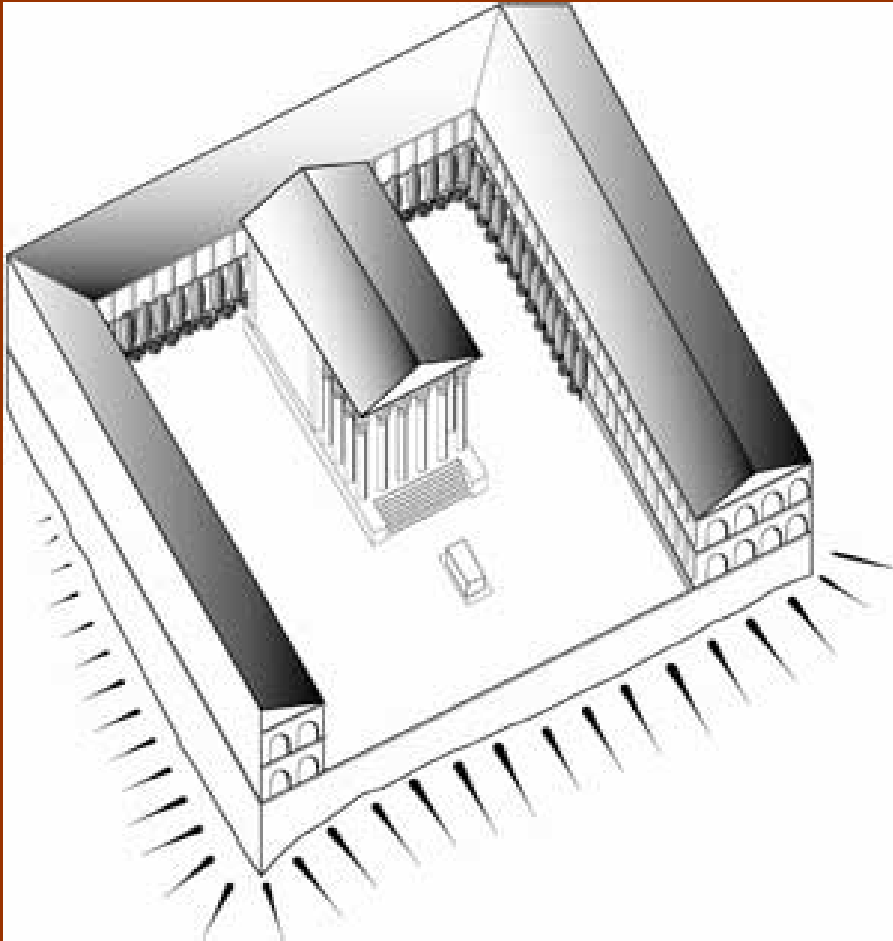

Orientation: southwards

Garden plantings  
(Sheffield excavation)



Temple of  
Apollo

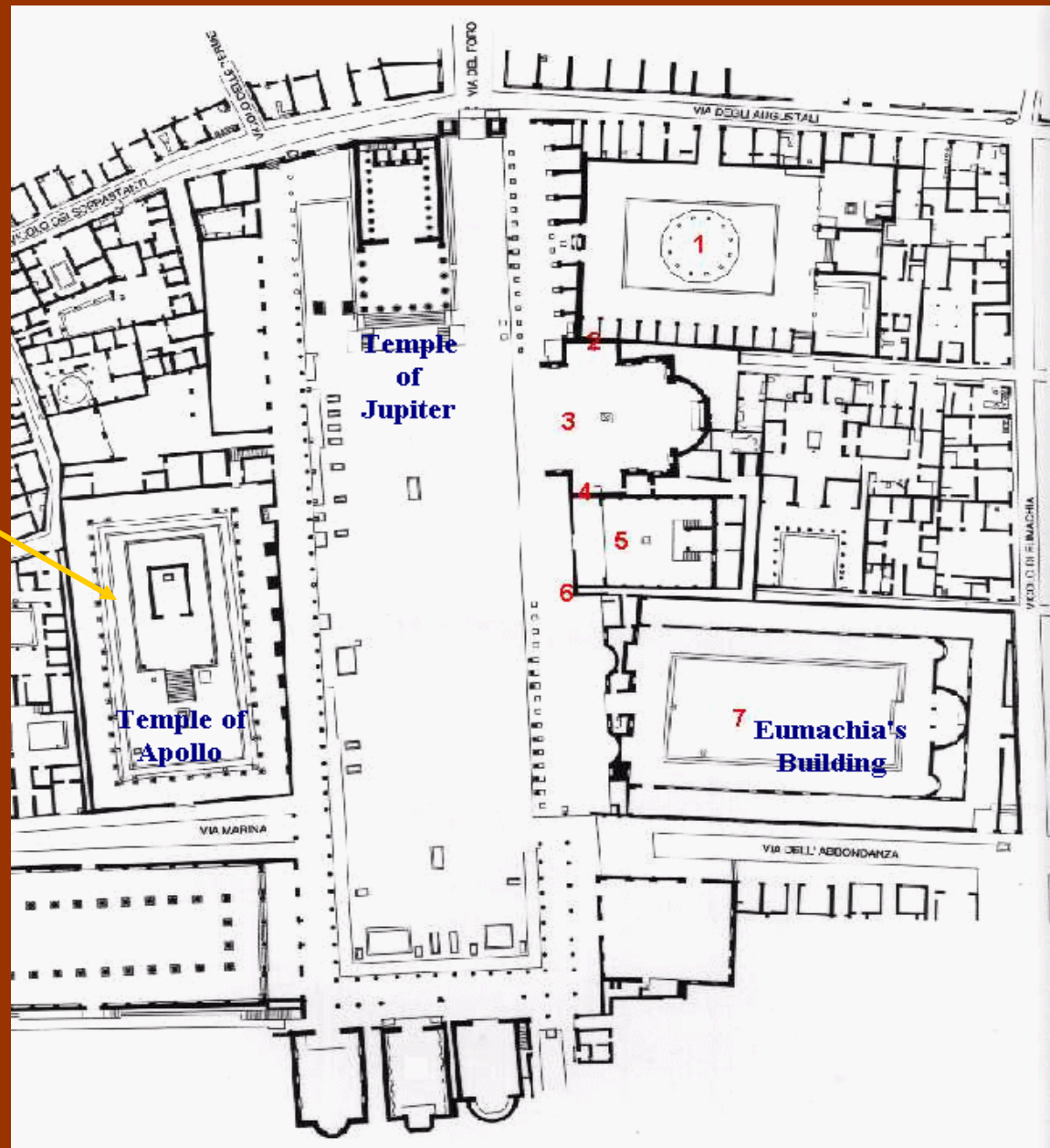

# Temple of Apollo

Plan (Dobbins et al.)  
and location of  
trench

[pompeii.virginia.edu  
/demo.html](http://pompeii.virginia.edu/demo.html)

J.J. DOBBINS, L.F. BALL, J.G. COOPER, S.L. GAVEL, AND S. HAY

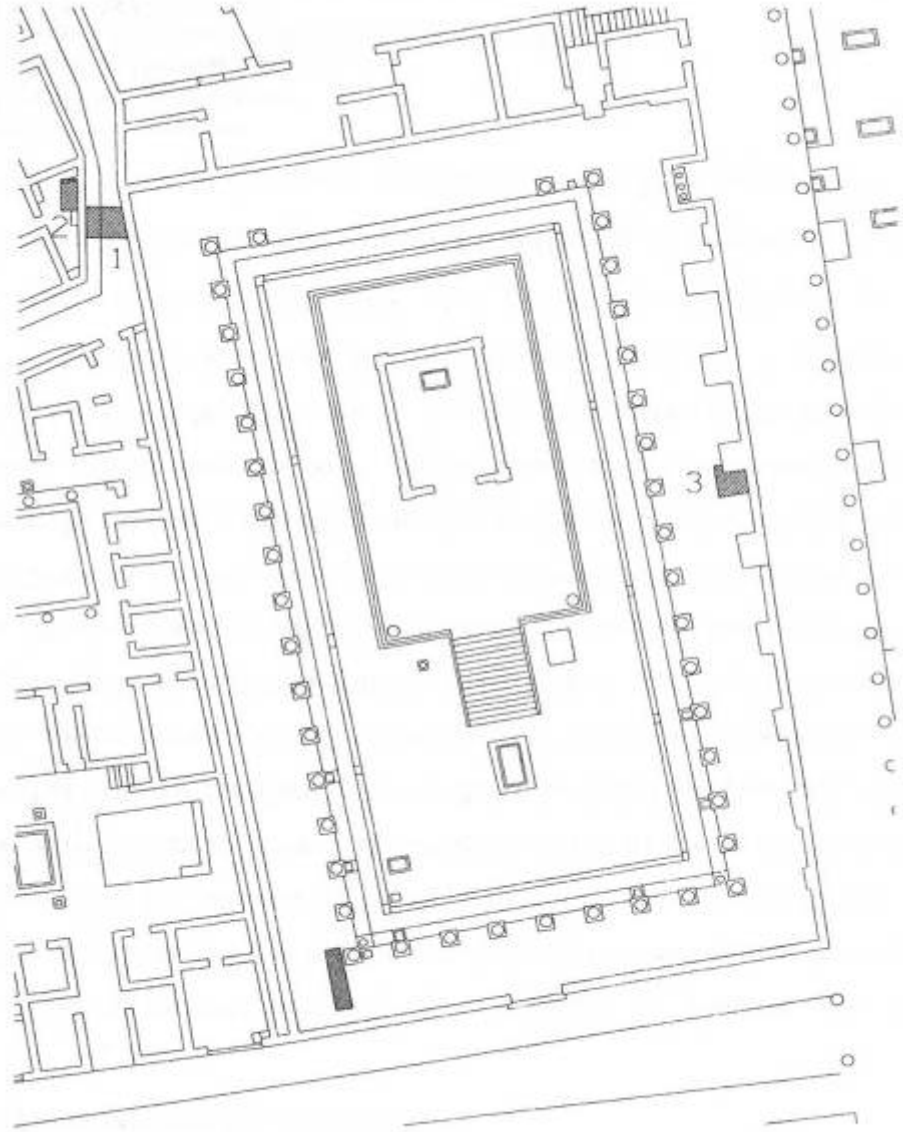

Fig. 4. Sanctuary of Apollo. Plan with the 1997 trenches indicated. Included is a wall discovered by A. Maiuri near the southwest corner of the sanctuary.

# Temple of Apollo: street plan after the Augustan changes?

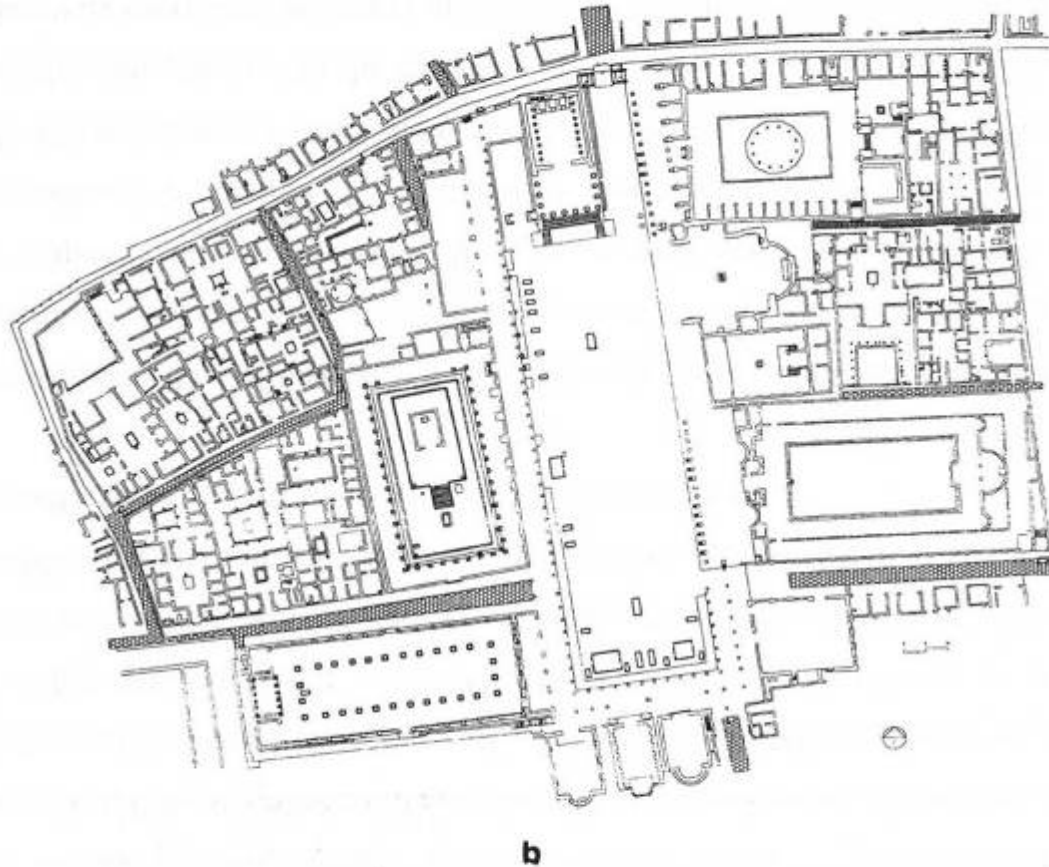
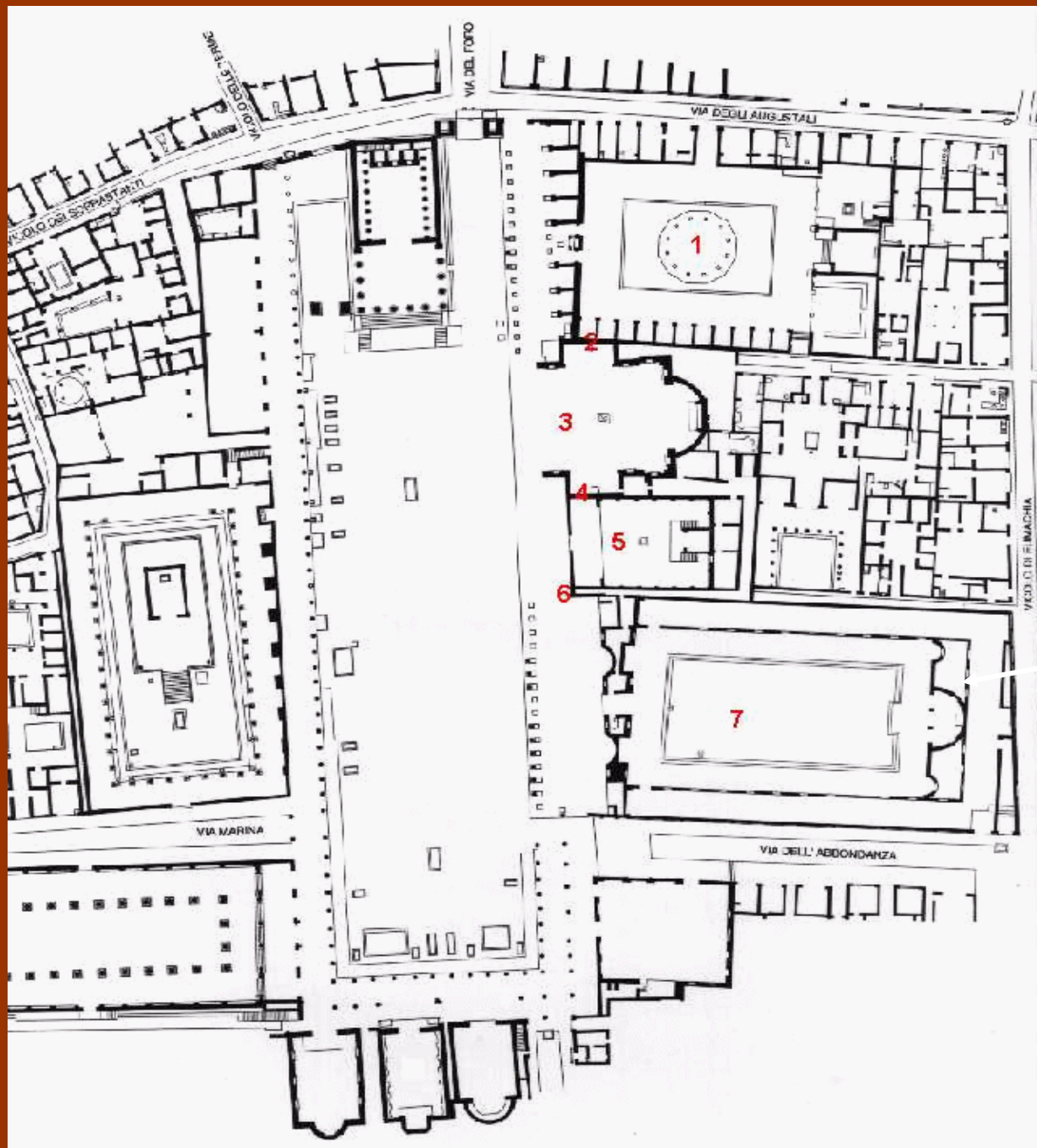

Fig. 1. The forum region: a) current street system highlighted; b) current and possible earlier street systems highlighted

CIL 10.787

M . HOLCONIVS . RVFVS . D . V . I . D . TER.  
C . EGNATIVS . POSTVMVS . D . V . I . D . TER.  
EX . D . D . IVS . LVMINVM  
OBSTRVENDORVM . HS . ∞ ∞ ∞  
REDEMERVNT . PARIETEMQVE  
PRIVATVM . COL . VEN . COR.  
VSQVE . AD . TEGVLAS  
FACIVND . COERARVNT.

Marcus Holconius Rufus, duumvir with judiciary authority for the third time and Gaius Egnatius Rufus duumvir with judiciary authority for the second time, in accordance with a decree of the Decuriones, purchased for 3000 sesterces the right to block the light and had a private wall constructed on behalf of Colonia Veneria Pompeianorum all the way to the roof tiles.



# Eumachia's building

Dating  
Eumachia's  
Building

Flavian?  
Augustan?

Dobbins  
The Forum  
Project

coigning

# Plan: Eumachia's building: Chalcidicum, crypta, porticus

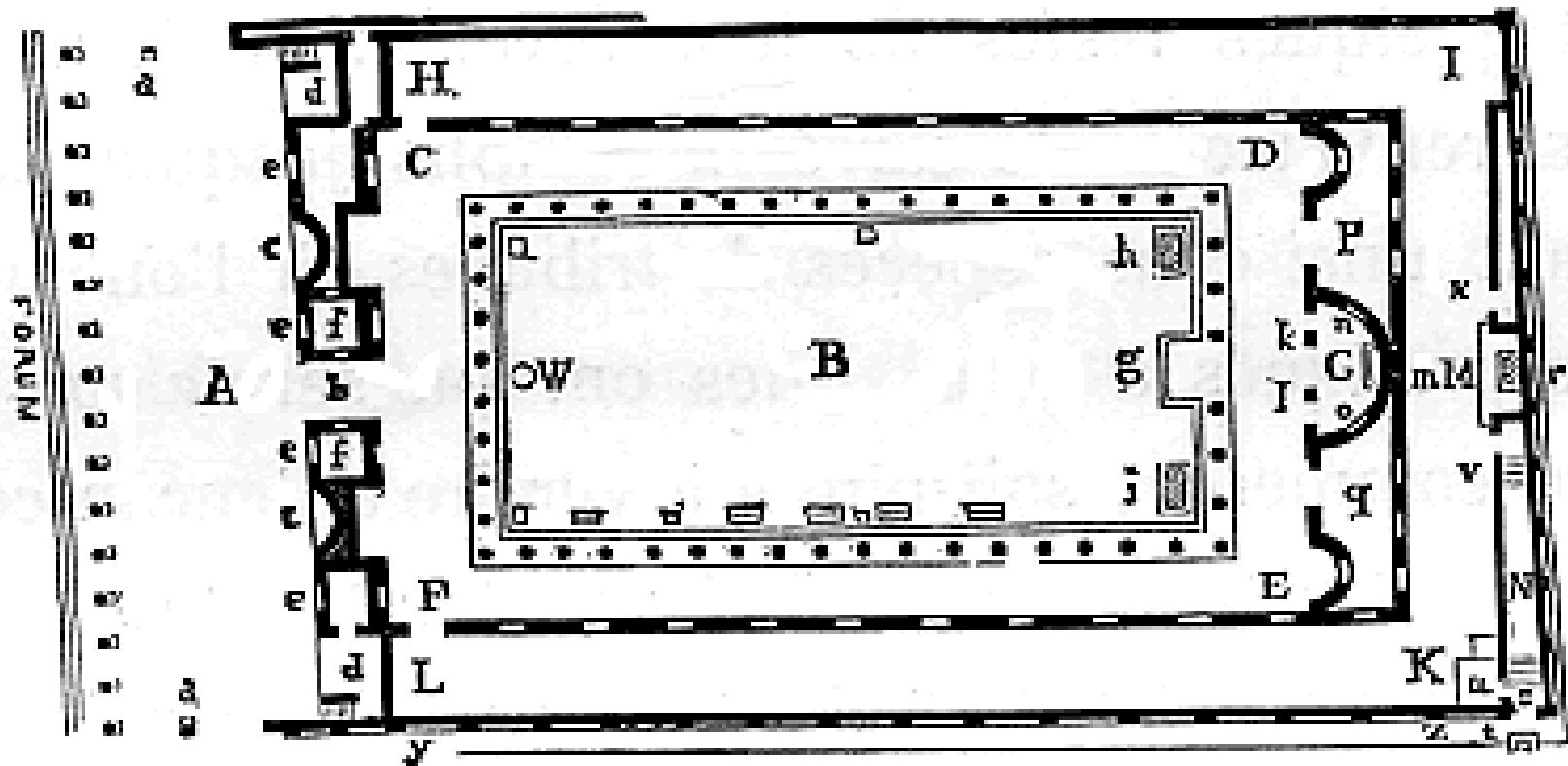

Eumachia, daughter of Lucius, public priestess, in her own name and in that of her son Marcus Numistrius Fronto, built a porch, a covered corridor, and a colonnade dedicated to the Augustan Concord and to Pietas, at her own expense. The same woman dedicated it.

EVMACHIA · L · F · SACERD · PVBL · NOMINE · SVO · ET  
M · NUMISTRI · FRONTONIS · FILI · CHALCIDICVM · CRYPTAM · PORTICVS · CONCORDIAE  
AVGVSTAE · PIETATI · SVA · PEQVNIA · FECIT · EADEMQVE · DEDICAVIT

EVMACHIA · L · F · SACERD · PVBL · NOMINE · SVO · ET  
M · NUMISTRI · FRONTONIS · FILI · CHALCIDICVM · CRYPTAM · PORTICVS · CONCORDIAE  
AVGVSTAE · PIETATI · SVA · PEQVNIA · FECIT · EADEMQVE · DEDICAVIT

EUMACHIA L F SACERD PUBL NOMINE SUO ET  
M NUMISTRI FRONTONIS FILI CHALCIDICUM CRYPTAM PORTICUS CONCORDIAE  
AUGUSTAE PIETATI SUA PEQUNIA FECIT EADEMQVE DEDICAVIT

# Entrance from the Forum:

Gate  
reconstructed by  
excavators

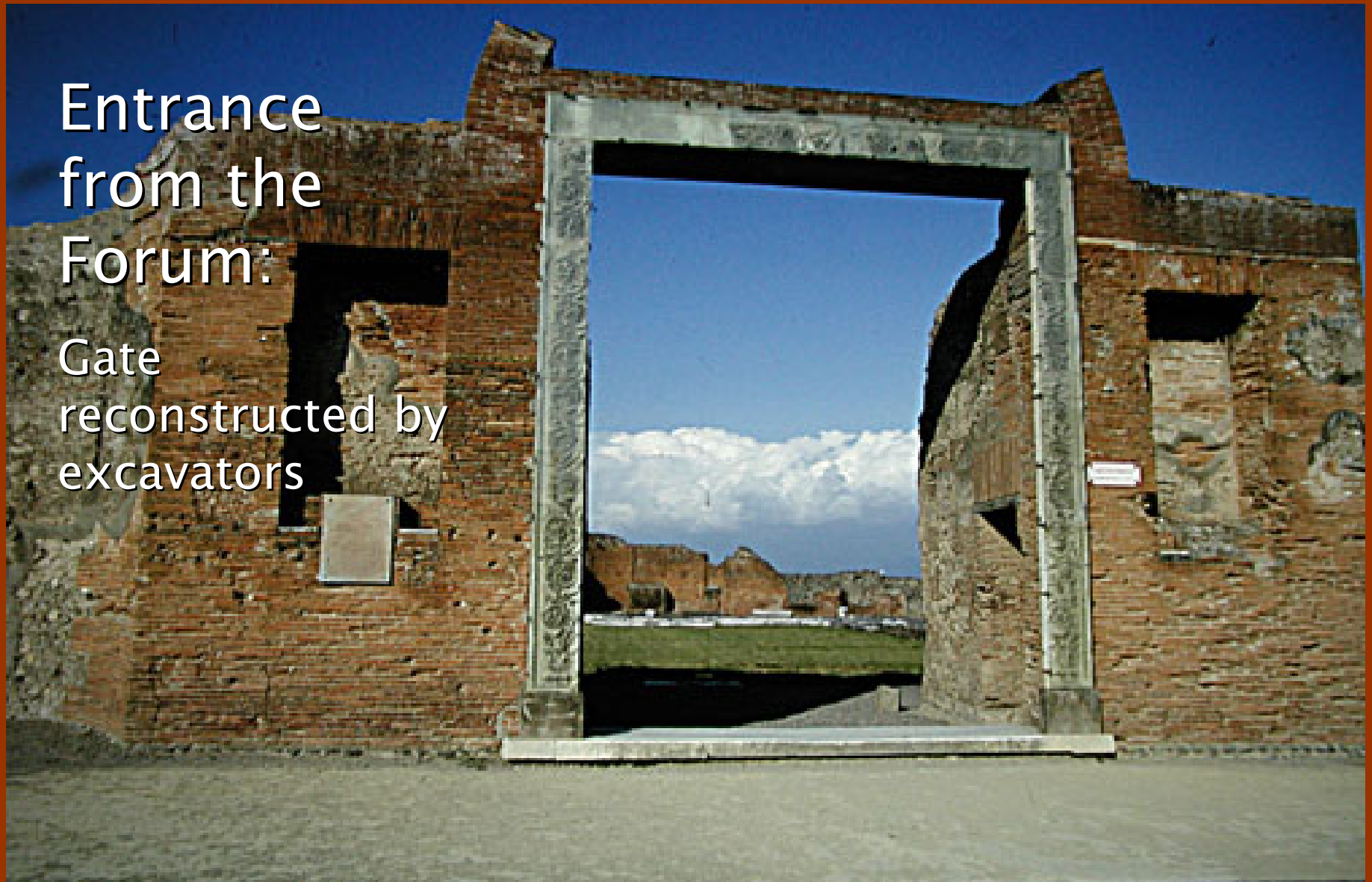





Eumachia: statue  
in Museo  
Nazionale Naples



Eumachia copy  
in original  
location

‘The Fullers  
(dedicate this) to  
Eumachia  
daughter of  
Lucius’

RÓMVLVS · MÁRTIS  
 ÍLIVS · VRBEM · RÓMAM  
*condi*DIT · ET · REGNAVIT · ANNÓS  
 DVODEQVADRAGINTÁ · ISQVE  
 5 PRIMVS · DVX · DVCE · HOSTIVM  
 ACRONE · REGE · CAENINENSIVM  
 INTERFECTO · SPOLIA · OPI*ma*  
 IOVI · FERETRIO · CONSECRA*uit*  
 RECEPTVSQVE · IN DEORV*m*  
 10 NVMERVM QVIRINVS  
 APPELLATVS *est . . . . .*

Romulus son of Mars  
 founded the city of Rome  
 and ruled it for 38 years. He  
 was the first general,  
 having killed the enemy  
 general King Acro of the  
 Caeninenses, to dedicate  
 the *spolia opima* to Jupiter  
 Feretrius and having been  
 taken in among the gods  
 was given the name of  
 Quirinus.

<http://www.amherst.edu/~classics/DamonFiles/classics36/eumachia.html>





VESONIVS VESONTAEVS MORFILLVS  
VIVENS VIVENS VIVENS VIVENS  
VIVENS VIVENS VIVENS VIVENS  
VIVENS VIVENS VIVENS VIVENS









View of entrance  
from the Forum

- Eumachia: dedication to Augustan Concordia and Pietas ('Dutifulness')
- References to Romulus and Aeneas (Forum of Augustus)

# The Big Smoke: what's happening in Rome?



# Imperial Forum projects

Forum of Augustus

Forum of Domitian (Nerva)

Forum of Caesar



# Forum of Augustus

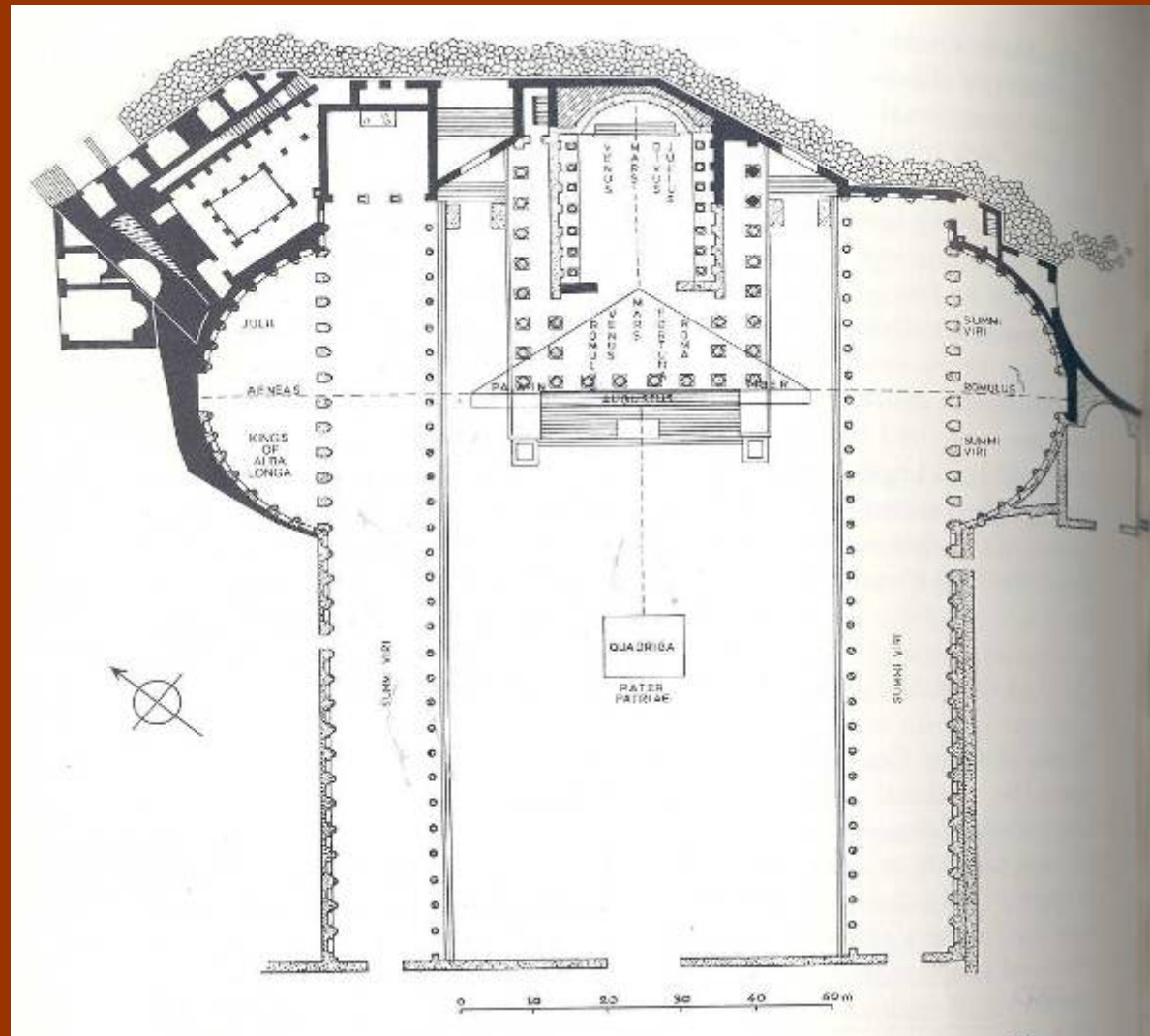

RÓMVLVS · MÁRTIS  
ÍLIVS · VRBEM · RÓMAM  
*condi*DIT · ET · REGNAVIT · ANNÓS  
DVODEQVADRAGINTÁ · ISQVE  
5 PRIMVS · DVX · DVCE · HOSTIVM  
ACRONE · REGE · CAENINENSIVM  
INTERFECTO · SPOLIA · OPI*ma*  
IOVI · FERETRIO · CONSECRA*uit*  
RECEPTVSQVE · IN DEORV*m*  
10 NVMERVM QVIRINVS  
APPELLATVS *est* . . . . .

Romulus son of Mars  
founded the city of Rome  
and ruled it for 38 years. He  
was the first general,  
having killed the enemy  
general King Acro of the  
Caeninenses, to dedicate  
the *spolia opima* to Jupiter  
Feretrius and having been  
taken in among the gods  
was given the name of  
Quirinus.

<http://www.amherst.edu/~classics/DamonFiles/classics36/eumachia.html>



Fig. 256. *Fortunae Muliebris aedes, templum*. L'iscrizione CIL VI 883 (da *Imagines* 2, n. 3422).

LIVIA [D]RUSI F VXOR [CAESARIS AUGUSTI ---  
 IMPP C[AES]S SEVERUS ET ANTO[NINVS AUGG ET GETA  
 NOBILISSIMUS CAESAR]  
 ET [IVLIA] AVG MATER AVG[G ---RESTITUERUNT

Livia's rededication of the Temple of Womanly Fortune?

# Livia's Porticus and the Shrine to Concordia

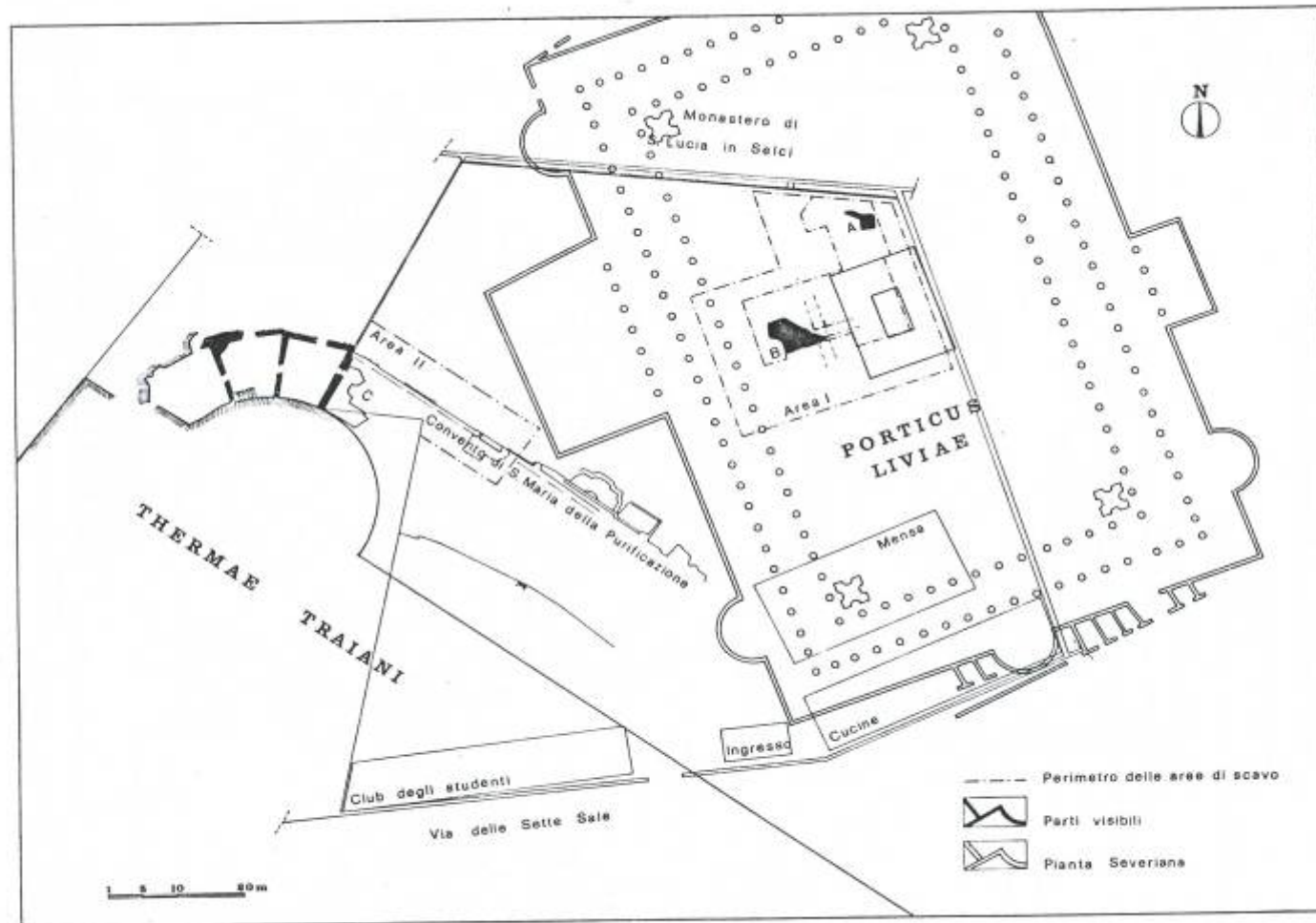
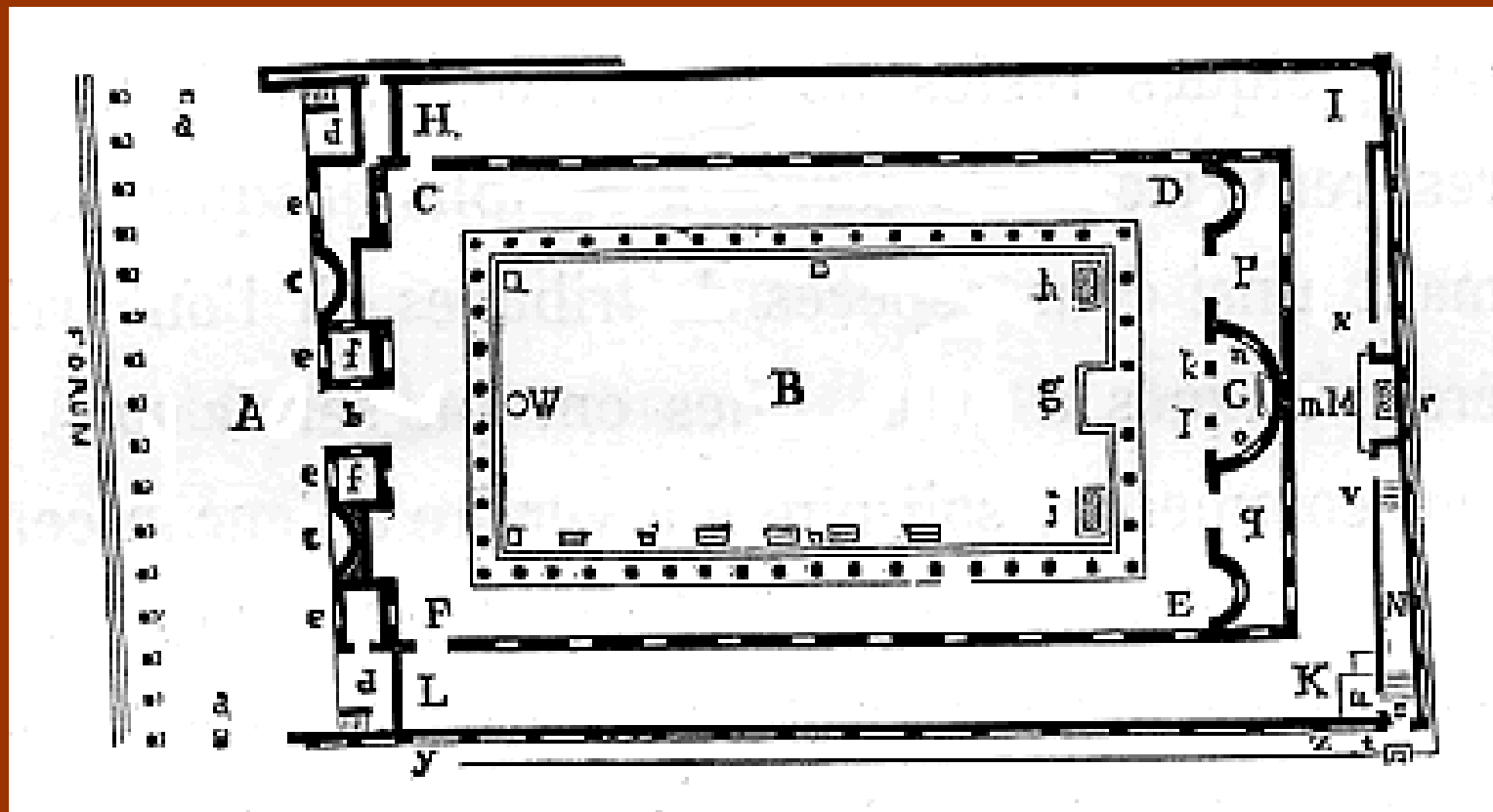

Fig. 47. *Porticus Liviae*. Planimetria generale (da L. Cozza - C. Panella, in *Roma II* (1985), 477 fig. 10).



Eumachia plan

The *Domi Nobiles* of Paestum (Torelli)

ILP n. 85

[C. (?) Cocceio – f.] C. n.

[Fla]c[o, quaesto]ri lecto

ab di[vo Caesa]re, legato

M'. Ota[cili Crassi] in Bithinia

pro [pr(aetore), agros de Ap]amaea divisit,

Min[eia (M.f.)] uxor

Mineia daughter of Marcus the wife dedicates (a statue) to C. Cocceius Flaccus, son of Gaius, grandson of Gaius, quaestor chosen by the Divine Julius, legate of M. Otacilius Crassus in Bithynia, proprætor for the division of lands in Apamea

- M Mineio Mf Mn Flacco trib mil Mineia soror (sister)
- L Mineio Mf Mn Mineia soror
- Mineia Mf uxor (wife)
- C Cocceius Cf Cn Aequo Mineia avia (grandmother)
- Mineia Mf C C Coccei Flacci mater | C Coccei Iusti ab  
fundamentis | basilicam et ante basilicam sua pecunia  
| fecit porticus pavimentaue omnia

# MINEIA, WIFE OF COCCEIUS

Paestum (Lucania)

[M. Mineius M. f]

[C. Cocceius C. f]

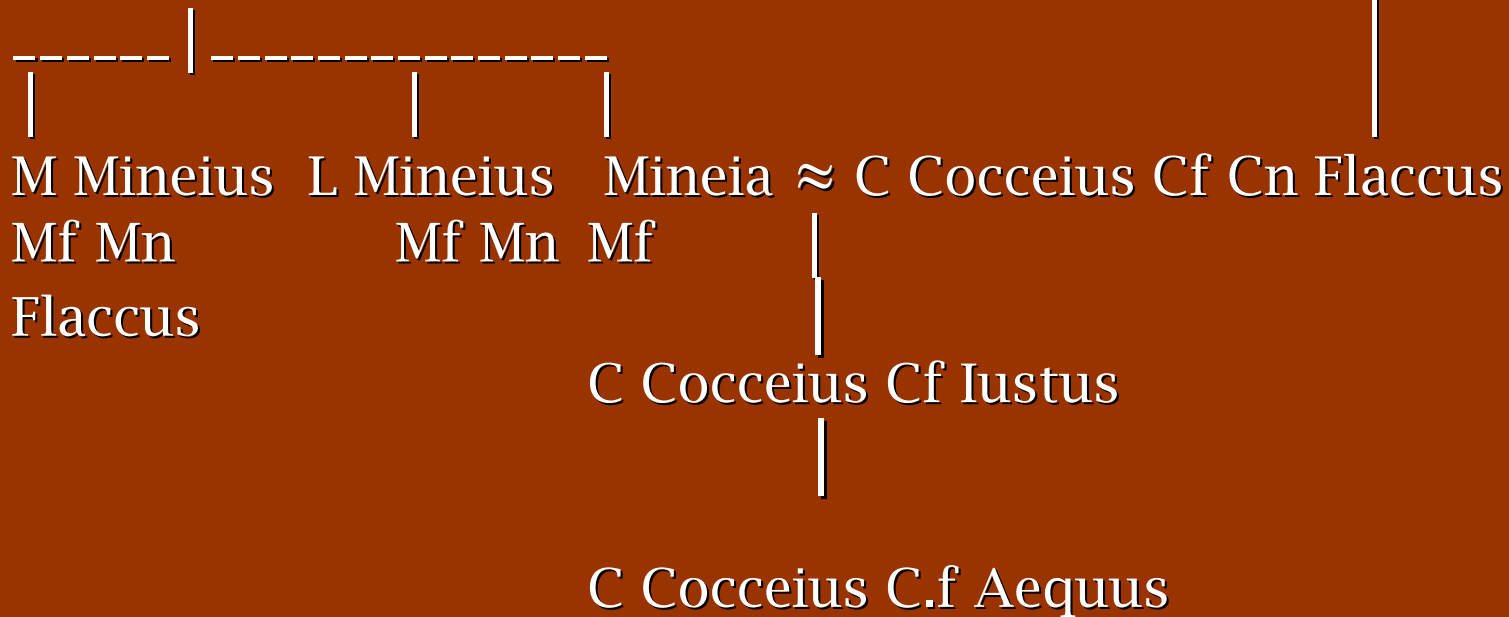

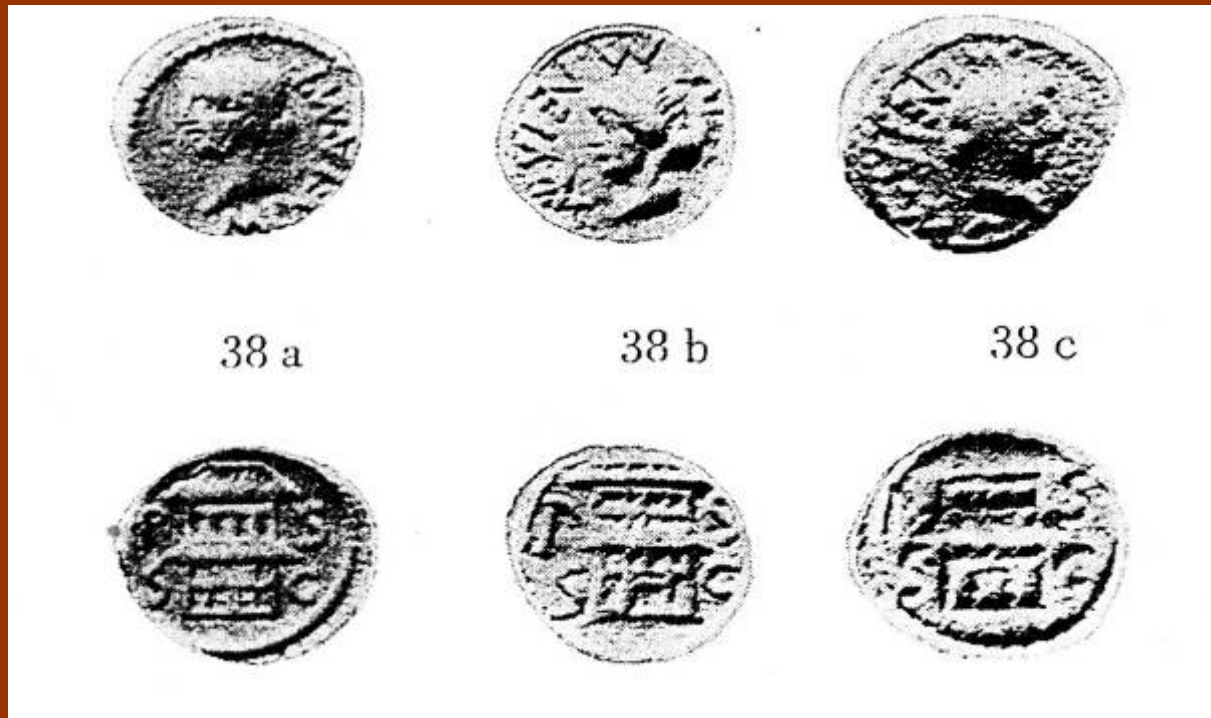

Bronze coins celebrating Mineia and the rebuilding of  
the Basilica in Paestum

Mineia Mf Paestum semis senatus consulto

# The Forum at Paestum

Mario TORELLI

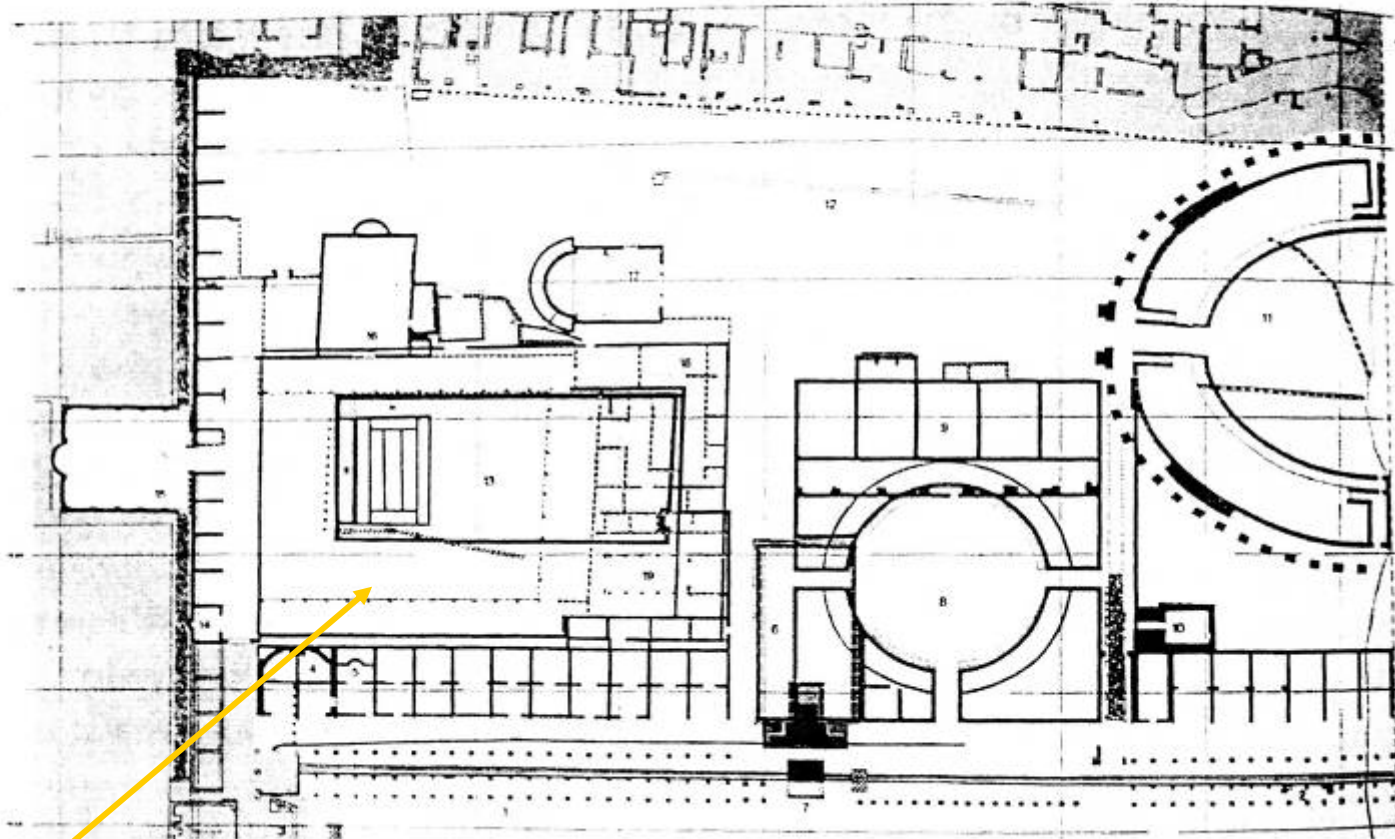

Fig. 3. Paestum, l'area del foro.

Basilica